

01 PLANTA BAIXA
Esc: 1/75

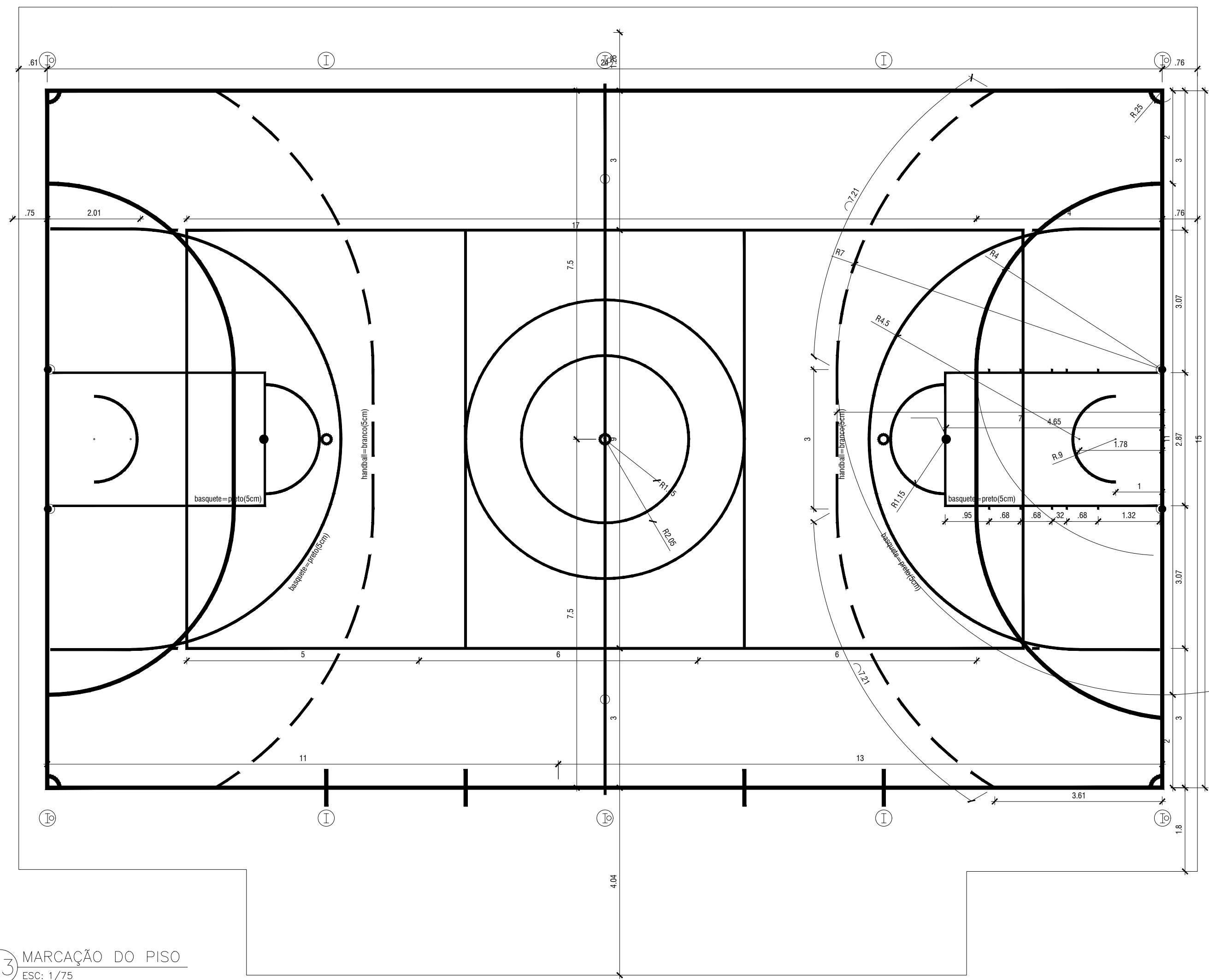

02 PLANTA DE COBERTURA
Esc: 1/75

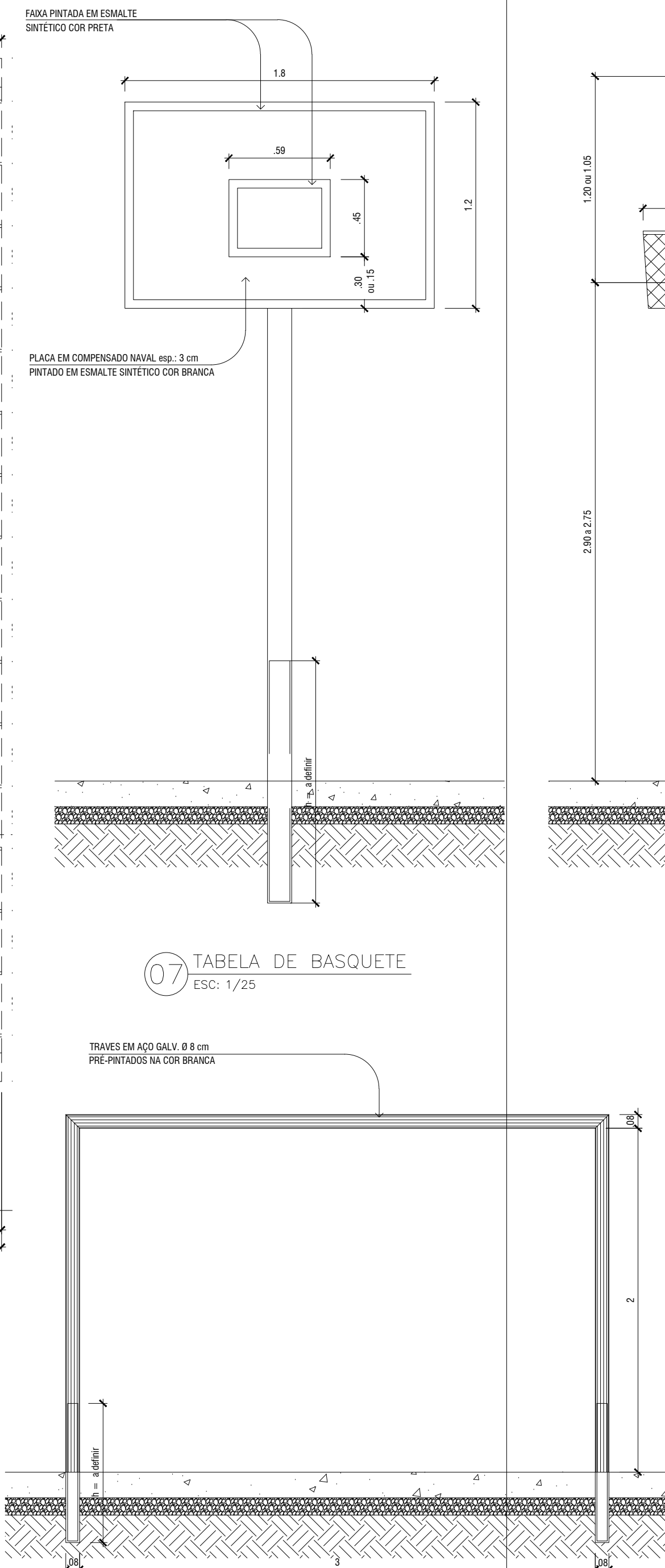
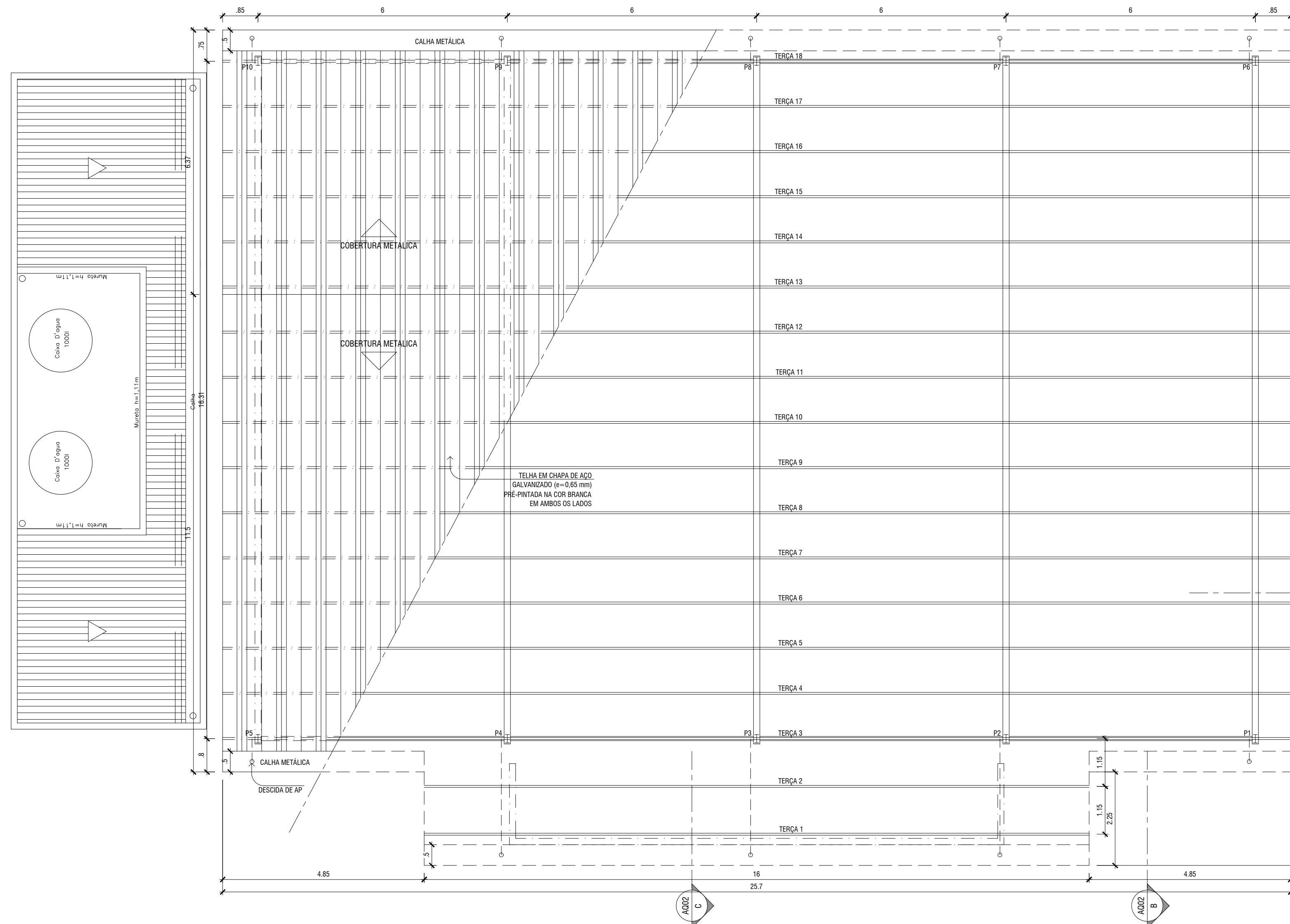

07 TABELA DE BASQUETE
Esc: 1/25



08 TRAVE DE FUTSAL
Esc: 1/25

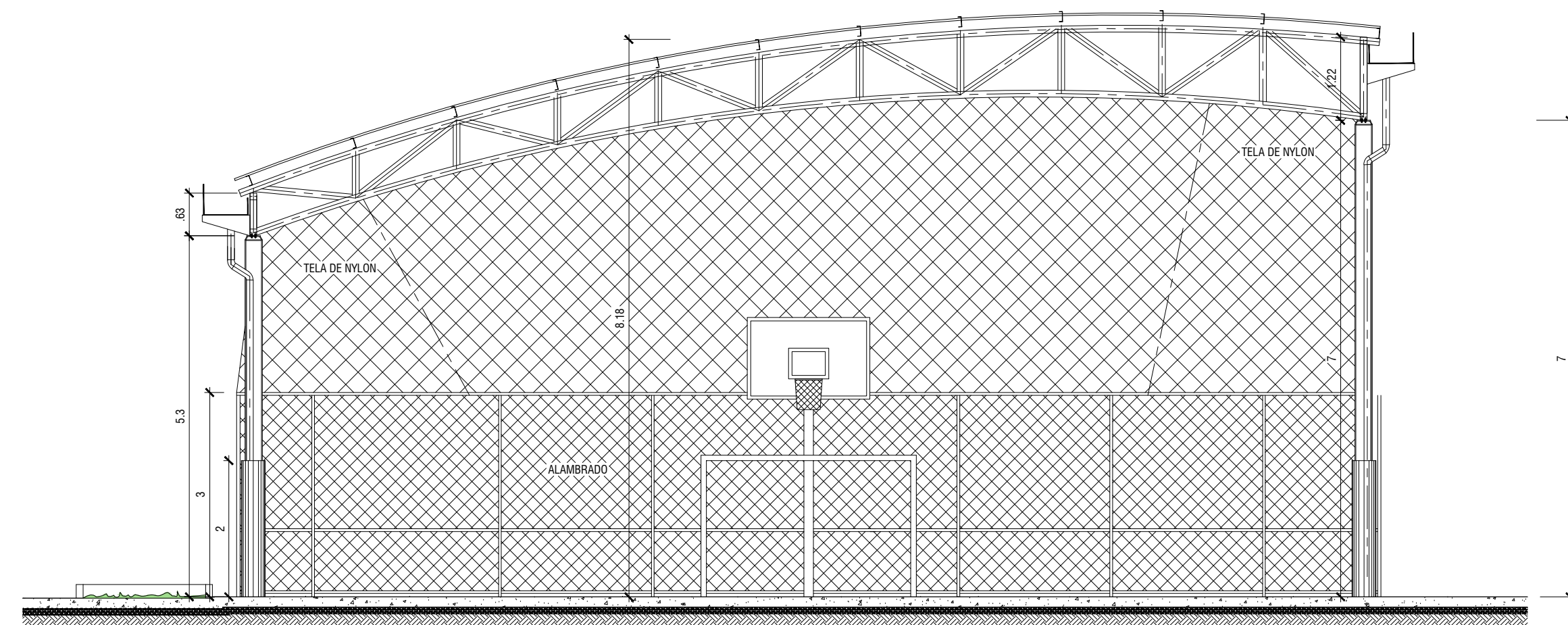

05 CORTE TRANSVERSAL 01
Esc: 1/75

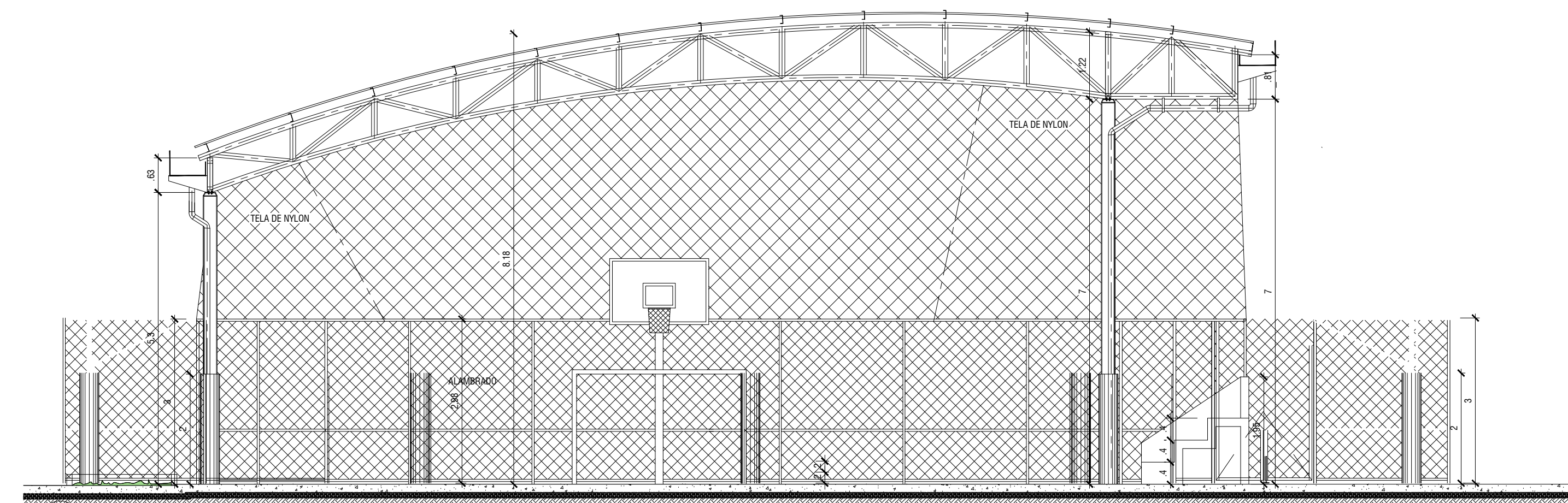

06 CORTE TRANSVERSAL 02
Esc: 1/75

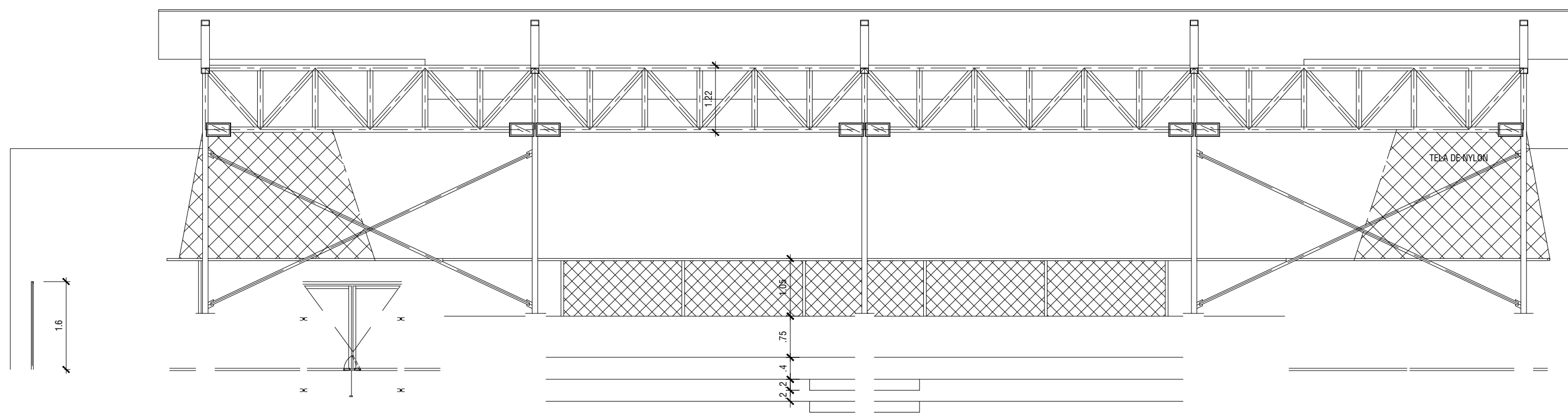

04 CORTE LONGITUDINAL
Esc: 1/75

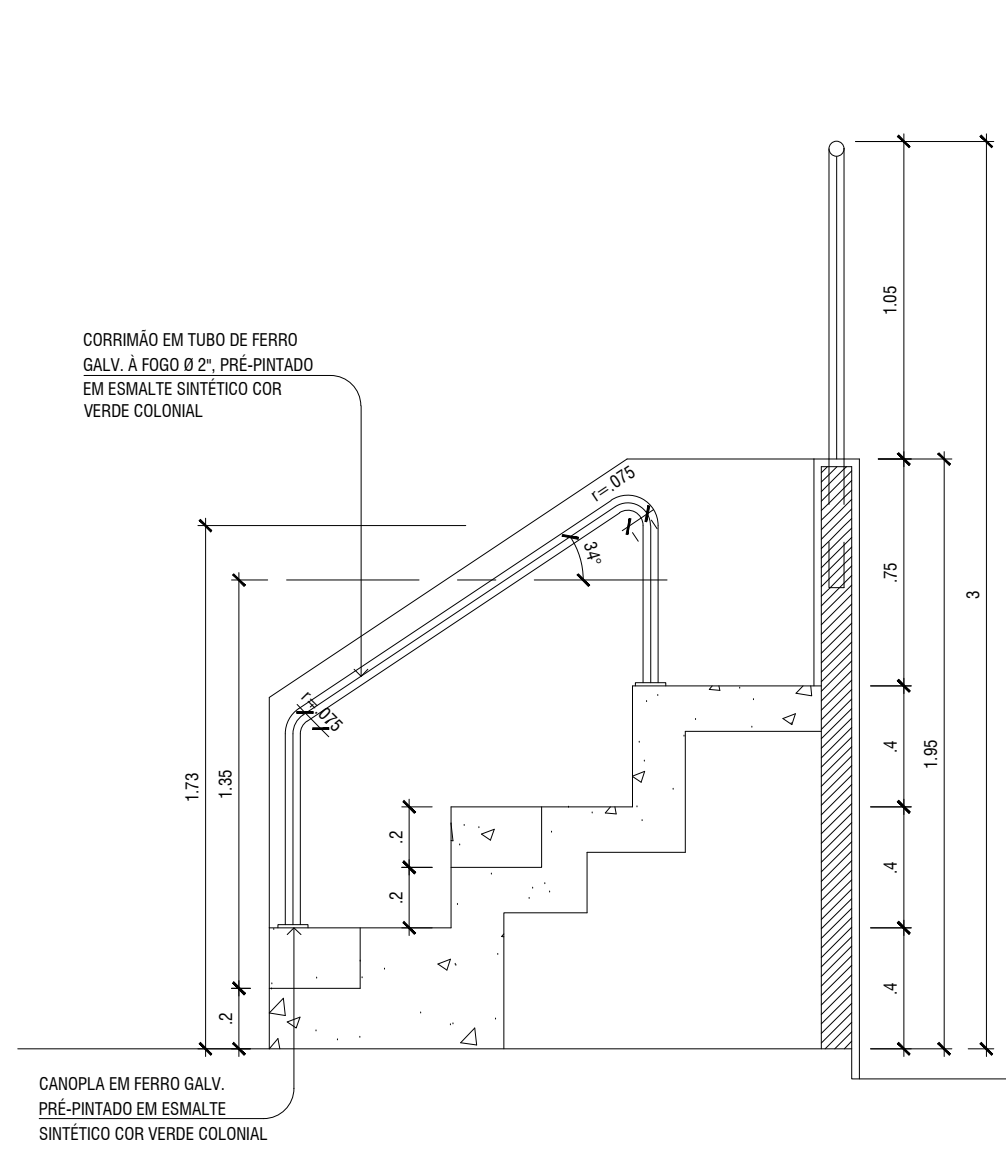

10 CORTE ARQUIBANCADA
Esc: 1/25

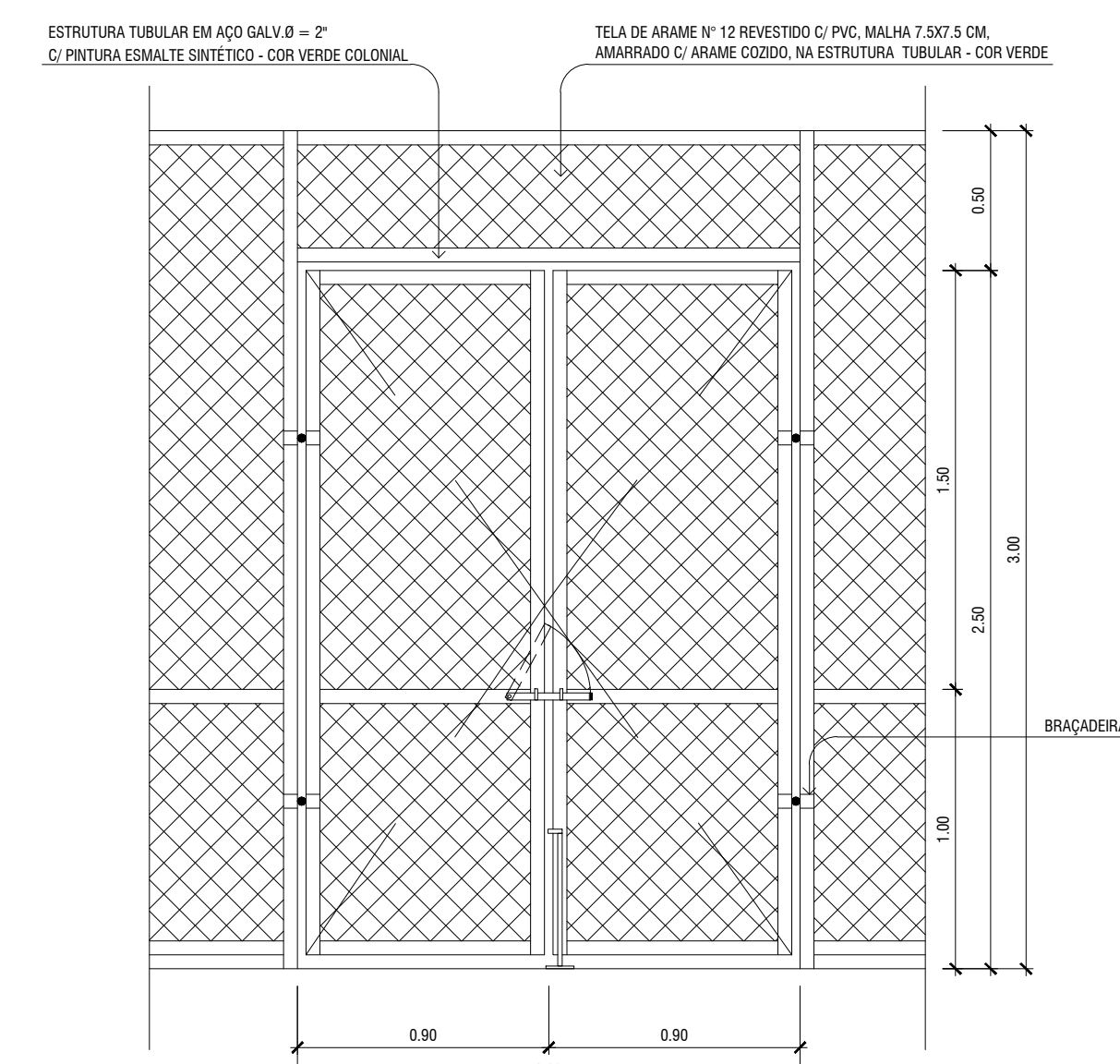

09 PORTA DE ALAMBRADO
Esc: 1/25

QUADRO DE ÁREAS		
Ambiente	Área (m²)	
Quadra poliesportiva	476,95	
Arquitetadas	23,20	
Cobertura	524,43	
Circulação - vestiários	8,24	
Depósito	10,26	
Vestibário feminino	19,90	
Vestibário masculino	19,90	
Sanitário P.N.E.	7,44	